



**MARTIN  
COMMERCIAL  
GROUP**  
Commercial Real Estate Services



# AVAILABLE FOR LEASE

5,000 SQ. FT. INDUSTRIAL SPACE



**For More Information  
Please Contact:**

**SAM GREEK**  
sgreek@mcgre.com  
DRE # 01899258

**LORI McAMIS**  
lmcamis@mcgre.com  
DRE # 01873441

## 1567 EAST EDINGER AVENUE ~ SANTA ANA

### Features:

- Reception & Three Private Offices With Central HVAC
- Two (2) 12'x14' GL Loading Doors
- 200A 3P 120/208V (Verify)
- 18' Warehouse Clear Height
- Drive Through Building
- Easy Access to 55, 5, 405, & 22 Freeways
- Professionally Managed

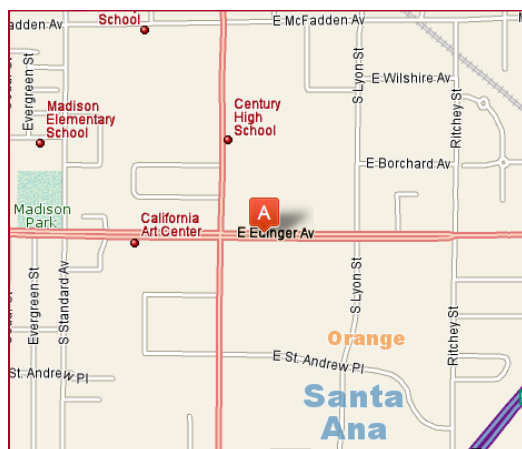

**714.241.1141**

1495 E. Warner Avenue  
Santa Ana, CA 92705

*Since 1953...  
Orange County ~ Inland Empire*

The information contained herein has been obtained from sources we deem reliable. While we have no reason to doubt its accuracy, we do not guarantee it.



MARTIN  
COMMERCIAL  
GROUP

Commercial Real Estate Services



## 1567 E. Edinger Ave., Santa Ana, CA 5,000 Sq. Ft.

For More Information  
Please Contact:

**SAM GREEK**

sgreek@mcre.com  
DRE # 01899258

**LORI McAMIS**

lmcamis@mcre.com  
DRE # 01873441

**714.241.1141**

1495 E. Warner Avenue  
Santa Ana, CA 92705

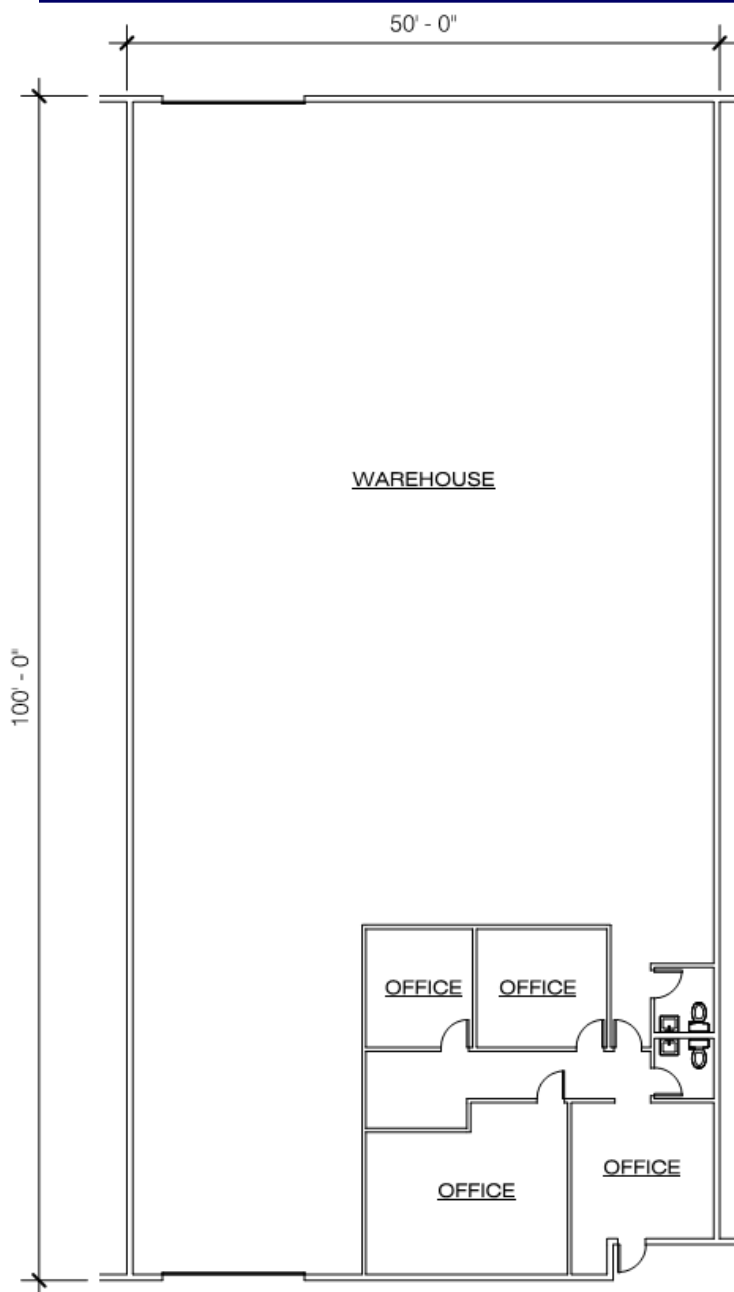

Since 1953...  
Orange County ~ Inland Empire

[WWW.MCGRE.COM](http://WWW.MCGRE.COM)