



**MARTIN
COMMERCIAL
GROUP**
Commercial Real Estate Services



AVAILABLE FOR LEASE

1,160 - 11,883 SQ. FT. FREE STANDING & MULTI-TENANT INDUSTRIAL BUILDING



1225 - 1281 W. 9th Street, Upland

MOUNTAINVIEW INDUSTRIAL PARK

- Offices w/Warehouse
- Fully Air Conditioned Offices
- Skylight(s)
- GL Loading Doors
- Ample Parking
- Nearby Shopping Mall/Restaurants
- Easy Access to 10 Fwy
- Professionally Managed

Other Amenities Available:

- Suspended Gas Heat in Warehouse
- Fenced Yards
- Dock High or Truckwell Loading

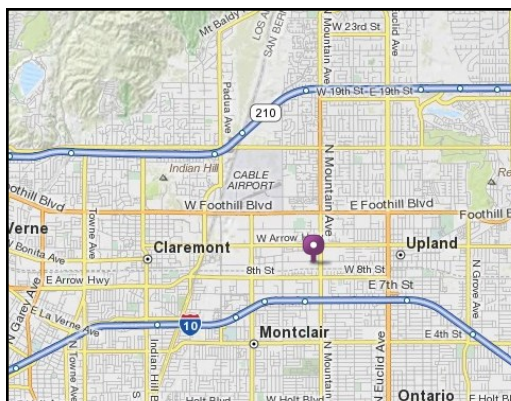

**For More Information
Please Contact:**

ERIN LAGOMARSINO

elagomarsino@mcgre.com
DRE # 00992436

951.684.1251

*Since 1953...
Orange County ~ Inland Empire*

The information contained herein has been obtained from sources we deem reliable. While we have no reason to doubt its accuracy, we do not guarantee it.



MARTIN
COMMERCIAL
GROUP

Commercial Real Estate Services



For More Information
Please Contact:

ERIN LAGOMARSINO

elagomarsino@mcgre.com
DRE # 00992436

951.684.1251

*Since 1953...
~Orange County~
Inland Empire*

1225 - 1281 W. 9th Street, Upland, CA

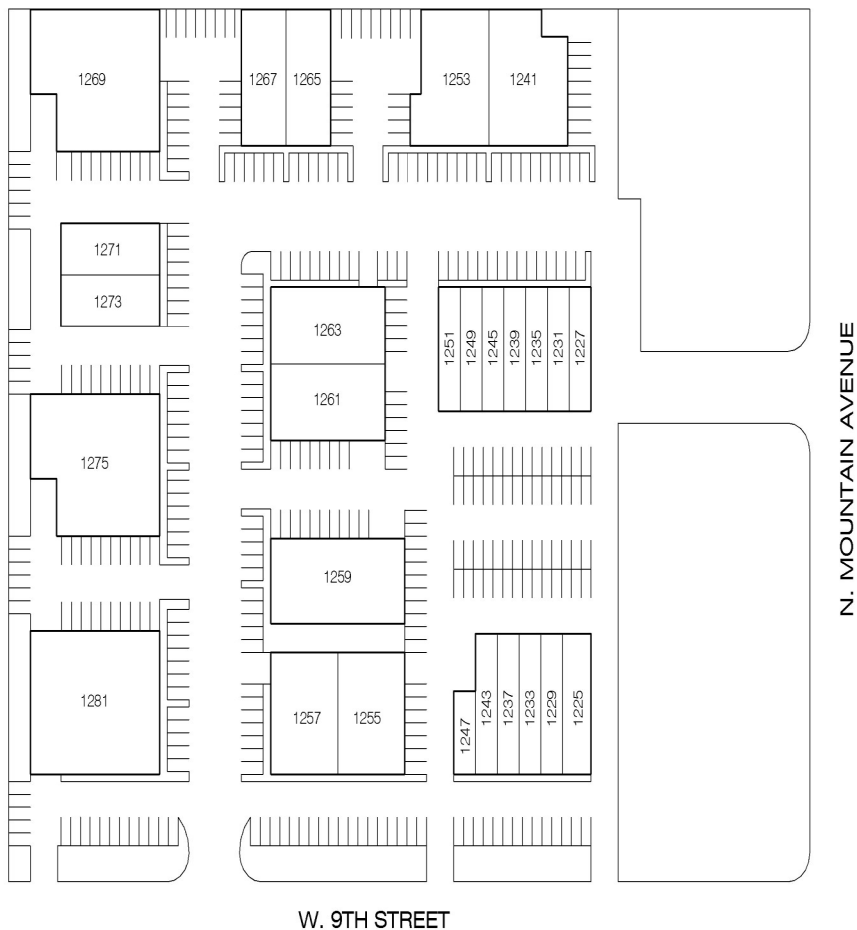

SITE PLAN - Mountain View Industrial Park, Upland

1" = 100'-0"



WWW.MCGRE.COM