



**MARTIN
COMMERCIAL
GROUP**

Commercial Real Estate Services



AVAILABLE FOR LEASE

**20,000 SQ. FT. FREE STANDING INDUSTRIAL BUILDING
KRAEMER BOULEVARD FRONTAGE**



1040 N. KRAEMER PLACE ~ ANAHEIM

Features:

- Approximately 2,000 Sq. Ft. Office
- Private Office, Open Bullpen Reception & Mezzanine Office
- Kraemer Blvd. Visibility
- Fire Sprinklers
- 400A 3Phase 120/208V (Verify)
- 18' Warehouse Clearance
- Three (3) 12'x14' GL Loading Doors
- Truck Well
- Easy Access to the 91, 55 & 57 Freeways
- Professionally Managed

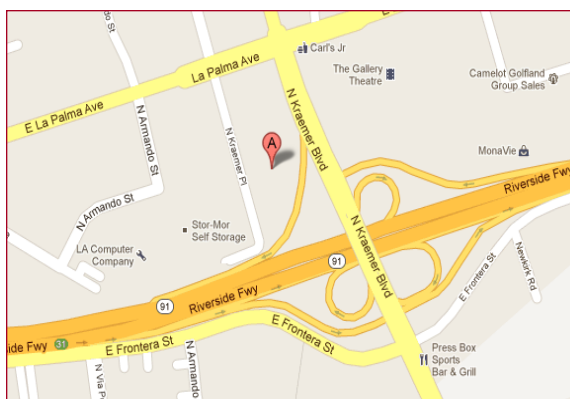

**For More Information
Please Contact:**

SAM GREEK

sgreek@mcgre.com
DRE # 01240614

KATELYN LOWDER

klowder@mcgre.com
DRE # 02042766

714.241.1141

1495 E. Warner Avenue
Santa Ana, CA 92705

*Since 1953...
Orange County ~ Inland Empire*

The information contained herein has been obtained from sources we deem reliable. While we have no reason to doubt its accuracy, we do not guarantee it.



MARTIN
COMMERCIAL
GROUP

Commercial Real Estate Services



For More Information
Please Contact:

SAM GREEK

sgreek@mcgre.com
DRE # 01240614

KATELYN LOWDER

klowder@mcgre.com
DRE # 02042766

714.241.1141

1495 E. Warner Avenue
Santa Ana, CA 92705

Since 1953...

**1040 N. Kraemer Place, Anaheim, CA
20,000 Sq. Ft.**

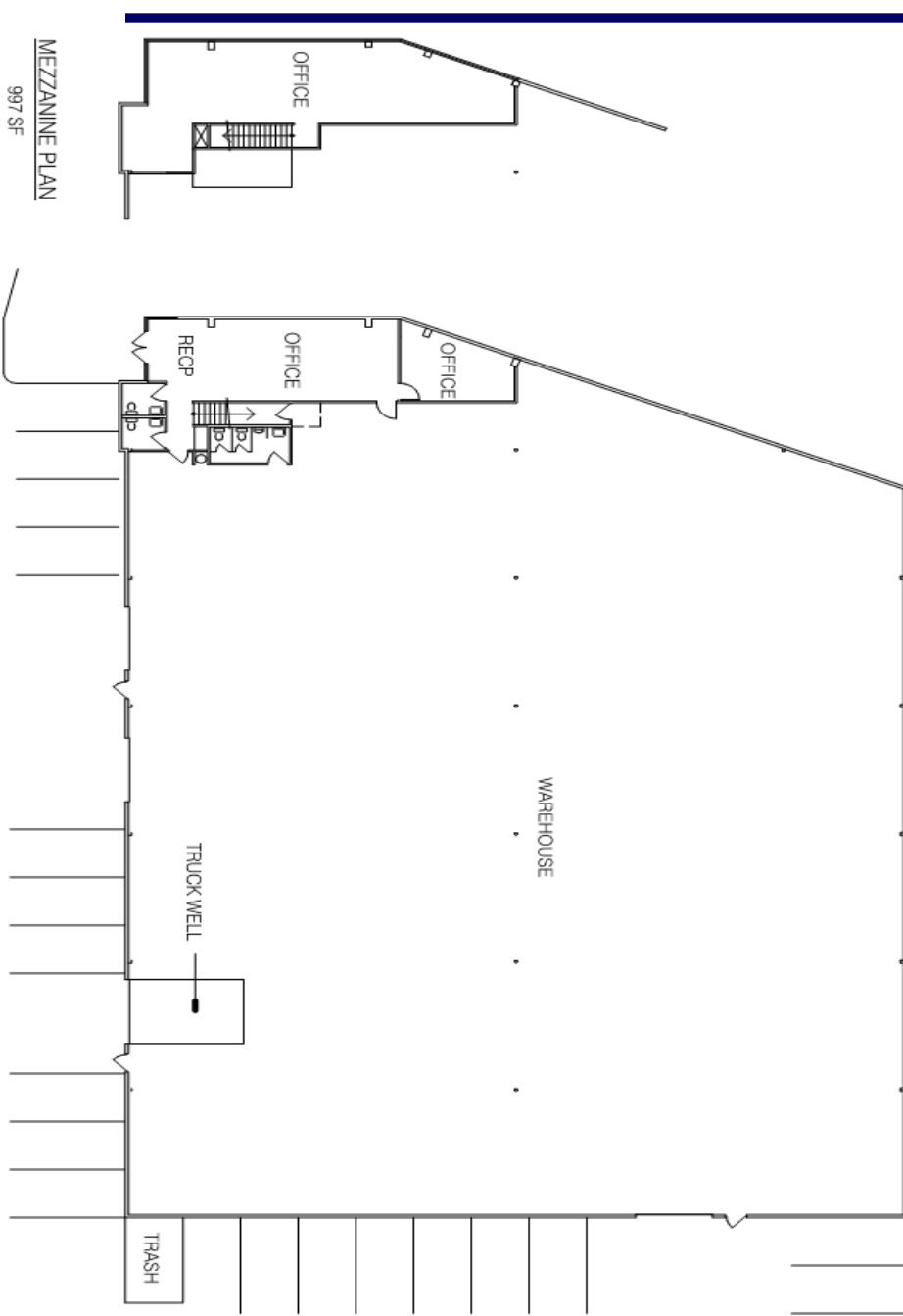

WWW.MARTINCOMMERCIALGROUP.COM