



**MARTIN
COMMERCIAL
GROUP**

Commercial Real Estate Services



AVAILABLE FOR LEASE

1,155 - 3,600 SQ. FT. MULTI-TENANT INDUSTRIAL BUILDINGS



6666 - 6700 Van Buren Blvd., Riverside

RIVERSIDE AIRPORT ONE

- Van Buren Blvd. Frontage
- Office/Showroom w/Warehouse
- Fully Air Conditioned Offices
- GL Loading Rear Doors
- 15' Warehouse Clearance
- Skylight (s)
- Ample Parking
- Professionally Landscaped
- Professionally Managed Complex
- Easy Access 60/91/215 Fwys

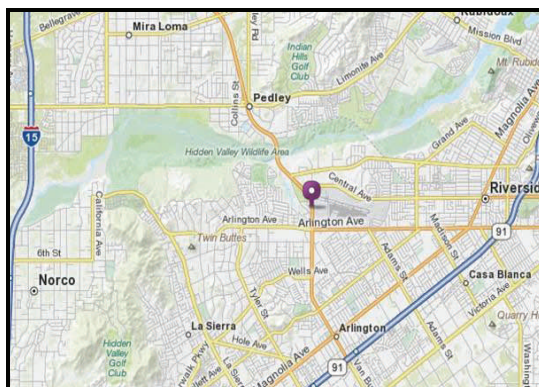

**For More Information
Please Contact:**

ERIN LAGOMARSINO

elagomarsino
@martincommercialgroup.com
DRE # 00992436

951.684.1251

3363 Chicago Avenue
Riverside, CA 92507

*Since 1953...
Orange County ~ Inland Empire*

The information contained herein has been obtained from sources we deem reliable. While we have no reason to doubt its accuracy, we do not guarantee it.



MARTIN
COMMERCIAL
GROUP

Commercial Real Estate Services



For More Information
Please Contact:

ERIN LAGOMARSINO

elagomarsino
@martincommercialgroup.com
DRE # 00992436

951.684.1251

3363 Chicago Avenue
Riverside, CA 92507

*Since 1953...
~Orange County~
Inland Empire*

6666 - 6700 Van Buren Blvd., Riverside

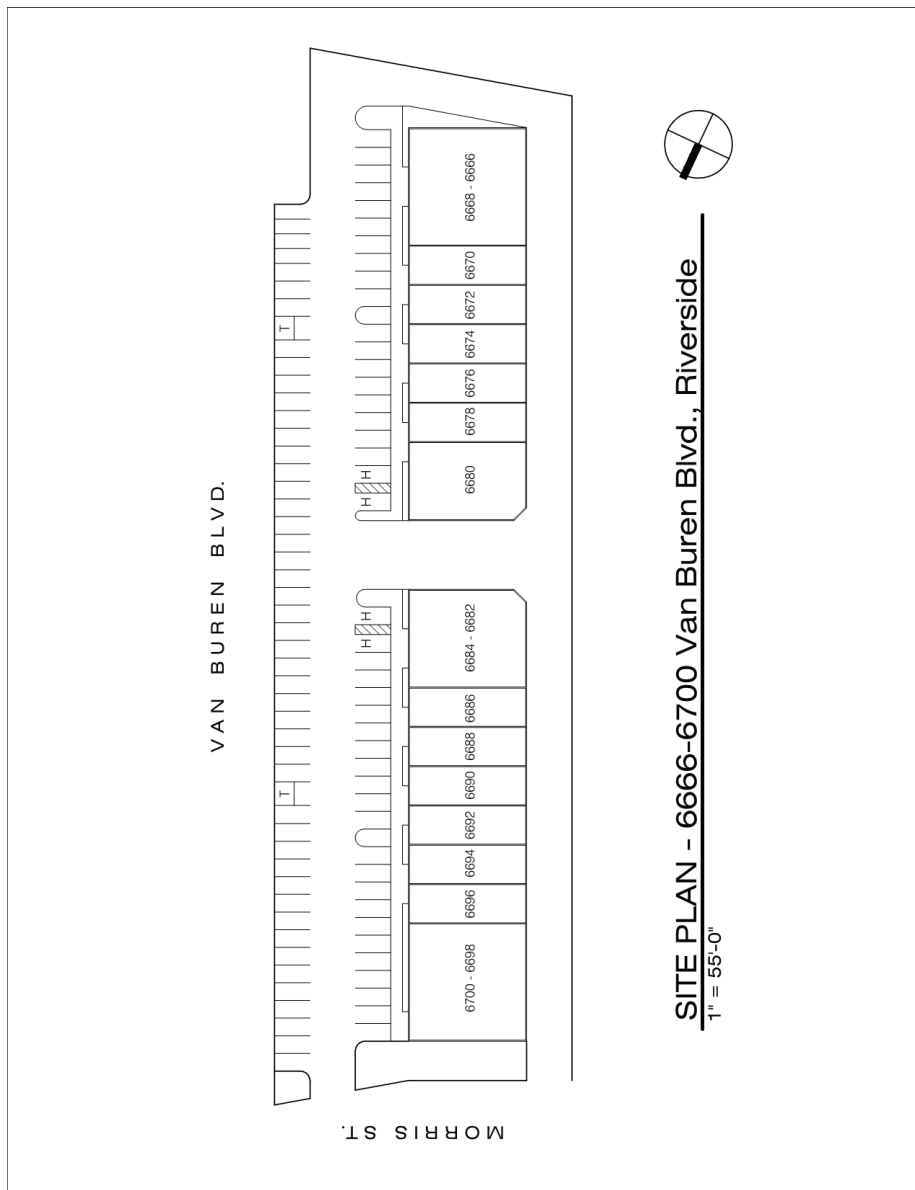

WWW.MARTINCOMMERCIALGROUP.COM