



**MARTIN
COMMERCIAL
GROUP**

Commercial Real Estate Services

AVAILABLE FOR LEASE

1,170 - 3,528 SQ. FT. MULTI TENANT INDUSTRIAL BUILDING



4025-4055 E. Guasti Rd., ONTARIO

GUASTI INDUSTRIAL PARK

- 100% Office or Office/Warehouse Suites
- Fully Air Conditioned Offices
- Fire Sprinklered or Heat Sensor
- Ground Level Loading Doors (Select Suites)
- Professionally Landscaped
- Professionally Managed Complex
- Easy Access to 10 & 15 Fwys.

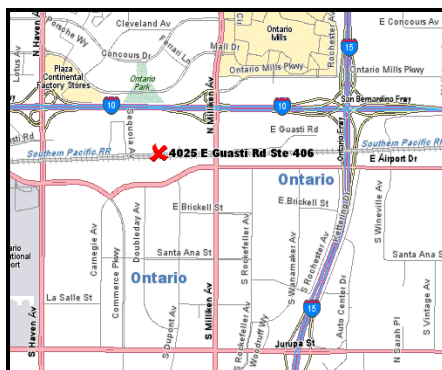

For More Information
Please Contact:

ERIN LAGOMARSINO

elagomarsino@mcgre.com
BRE # 00992436

951.684.1251

*Since 1953...
Orange County ~ Inland Empire*

The information contained herein has been obtained from sources we deem reliable. While we have no reason to doubt its accuracy, we do not guarantee it.



MARTIN
COMMERCIAL
GROUP

Commercial Real Estate Services



For More Information
Please Contact:

ERIN LAGOMARSINO

elagomarsino@mcgre.com
BRE # 00992436

951.684.1251

*Since 1953...
~Orange County ~
Inland Empire*

4025 - 4055 E. Guasti Rd., Ontario, CA

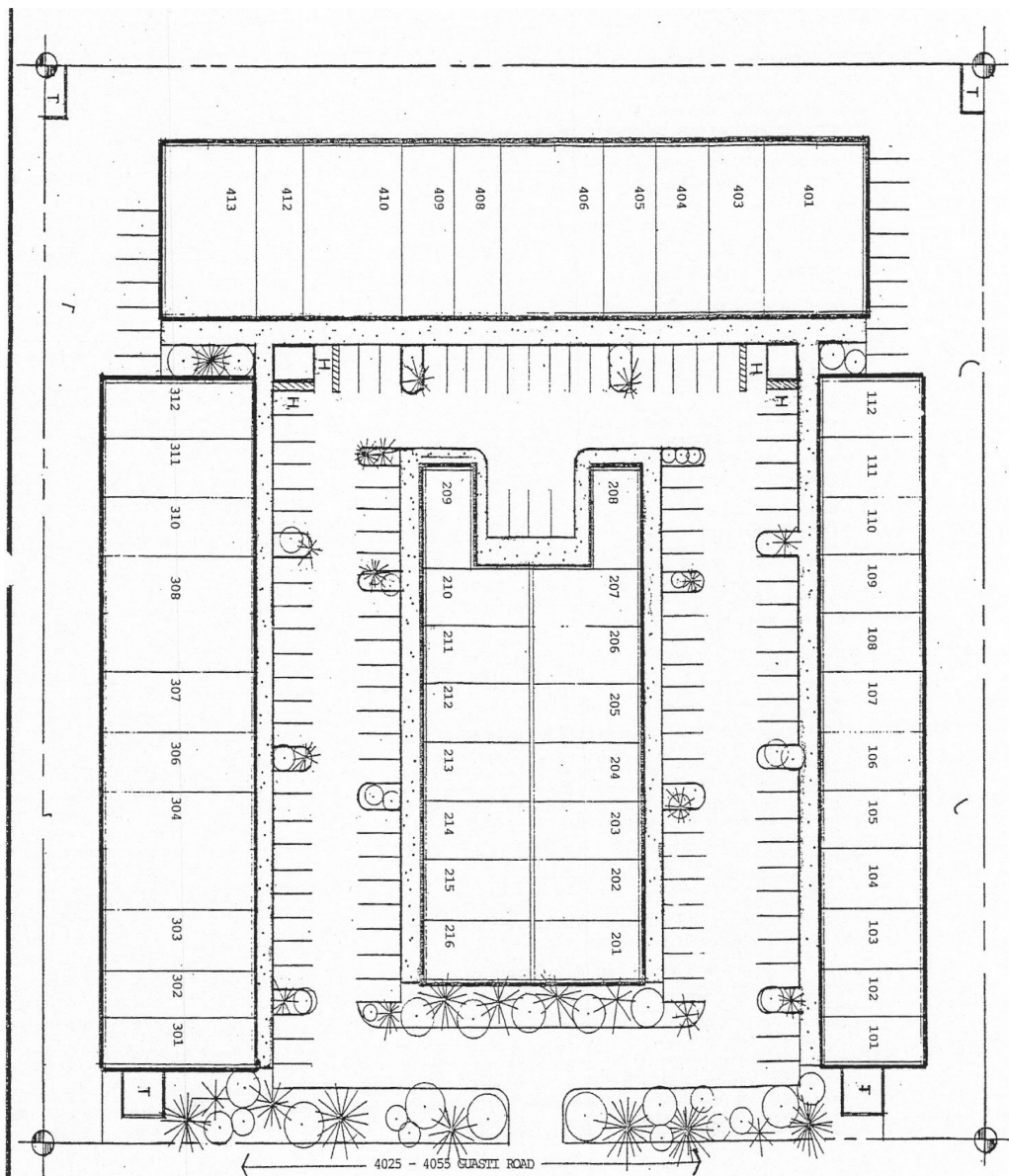

WWW.MCGRE.COM